



131 Lower Road, Salisbury, Wiltshire, SP2 9NJ

£210,000 Freehold

Character end terrace house in need of complete modernisation. Garden with rear pedestrian access, workshop and greenhouse.

Description

Character end terrace house in need of complete modernisation, situated in the highly sought after area of Lower Bemerton. There is a good garden with rear pedestrian access, workshop and greenhouse. The accommodation consists of entrance hall, sitting/dining room, kitchen, 2 bedrooms and bathroom. Vacant possession.

Entrance Hall

With stairs to first floor and understairs cupboard.

Sitting/Dining Room

Two fireplaces with gas fires, central timbers.

Kitchen

Sink unit, worksurface, base and wall cupboards, door to:

Sun room

Cupboard with wc, separate store cupboard.

First floor landing

Hatch to loft space.

Bedroom One

Bedroom Two

Bathroom

Bath, wc and basin. Cupboard housing lagged hot water tank.

Outside

Small front garden behind rendered wall. Good sized rear garden with workshop and greenhouse. Rear pedestrian access.

Services

All main services are connected.

Outgoings

The Council Tax Band is 'C' and the payment for the year 2025/2026 payable to Wiltshire Council is £2350.54.

Directions

From the city proceed out on the Wilton Road. Pass over Skewbridge and turn left into Church Lane. Take the second left into Lower Road.

WHAT3WORDS

What3Words reference is: ///armed.album.crust

Energy Efficiency Rating		
	Current	Potential
Very energy efficient - lower running costs		
(92 plus) A		
(81-91) B		
(69-80) C		
(55-68) D		
(39-54) E		
(21-38) F		
(1-20) G		
Not energy efficient - higher running costs		
England & Wales		EU Directive 2002/91/EC 

WHITES

Castle Chambers, 47 Castle Street,
Salisbury, Wiltshire, SP1 3SP

Tel: 01722 336422

www.hwwhite.co.uk

email: residential-sales@hwwhite.co.uk

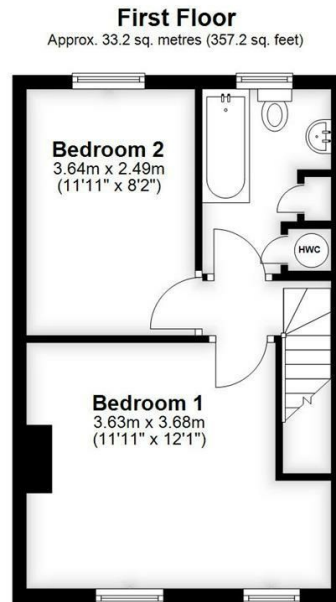
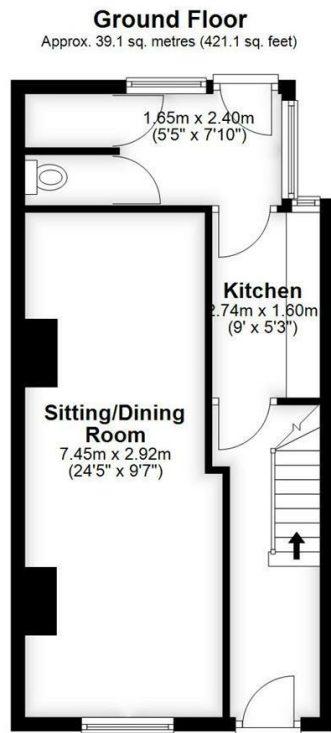

Total area: approx. 72.3 sq. metres (778.4 sq. feet)



